

# DewEze CLUTCH PUMP KIT

710036	Bracket Assy. (Inc. item 1)		Kit No.	700014
710464	Bracket Bolt Pkg. (Inc. items 2-4,10-13,24,26)		Make	Chevy
710433	Pulley Bolt Pkg. (Inc. items 10,18,19,24,25,27,28)		Engine	454
710359	Idler Bolt Pkg. (Inc. items 6,14-17,23)		Fuel	Gas
700186	Fan Spacer Bolt Pkg. (Inc. items 20-22)		Year	1988-93
			Options	Serp. Belt
			Revised	A 7-17-95

ITEM	PART #	DESCRIPTION	ITEM	PART #	DESCRIPTION
1.	710036	Pump Mounting Bracket	18.	110554	3/8 X 5 3/4 NF Bolt
2.	710125	4.60" Spacer ('88-'91)	19.	110549	1/2 X 6 NF Bolt
3.	710731	4.54" Spacer ('92-'93)	20.	710350	8mm X 65mm X 1.25 thd.
4.	710732	3.78" Spacer ('92-'93)	21.	110674	8mm Lock Washer
5.	740040	Idler Pulley	22.	110643	8mm X 1.25 thd. Nut
6.	710613	1.12" Spacer	23.	110639	5/8" Lock Nut
7.	*	Pump	24.	110672	3/8 Lock Washer
8.	740025	Crankshaft Pulley	25.	110676	3/8 Flat Washer
9.	700172	Fan Spacer	26.	110671	7/16 Lock Washer
10.	110548	3/8 X 5 3/4 NC Bolt	27.	110666	1/2 Lock Washer
11.	110522	7/16 X 6 NC Bolt	28.	110658	1/2 Flat Washer
12.	110425	3/8 X 1 1/4 NC Bolt	29.	740058	V-belt, A62 with Std. Clutch
13.	110435	3/8 X 1 1/2 NC bolt	29.	740057	V-belt, A61 with H.D. Clutch
14.	110385	5/8 X 4 NC Bolt	30.	740037	Clutch, Standard
15.	110668	5/8 Machine Bushing (10 ga.)		740038	Clutch, Heavy Duty
16.	110669	5/8 Machine Bushing (14 ga.)	31.	710353	Footmount
17.	110650	5/8 Flat Washer			

\* See Master List For Pump Part No.

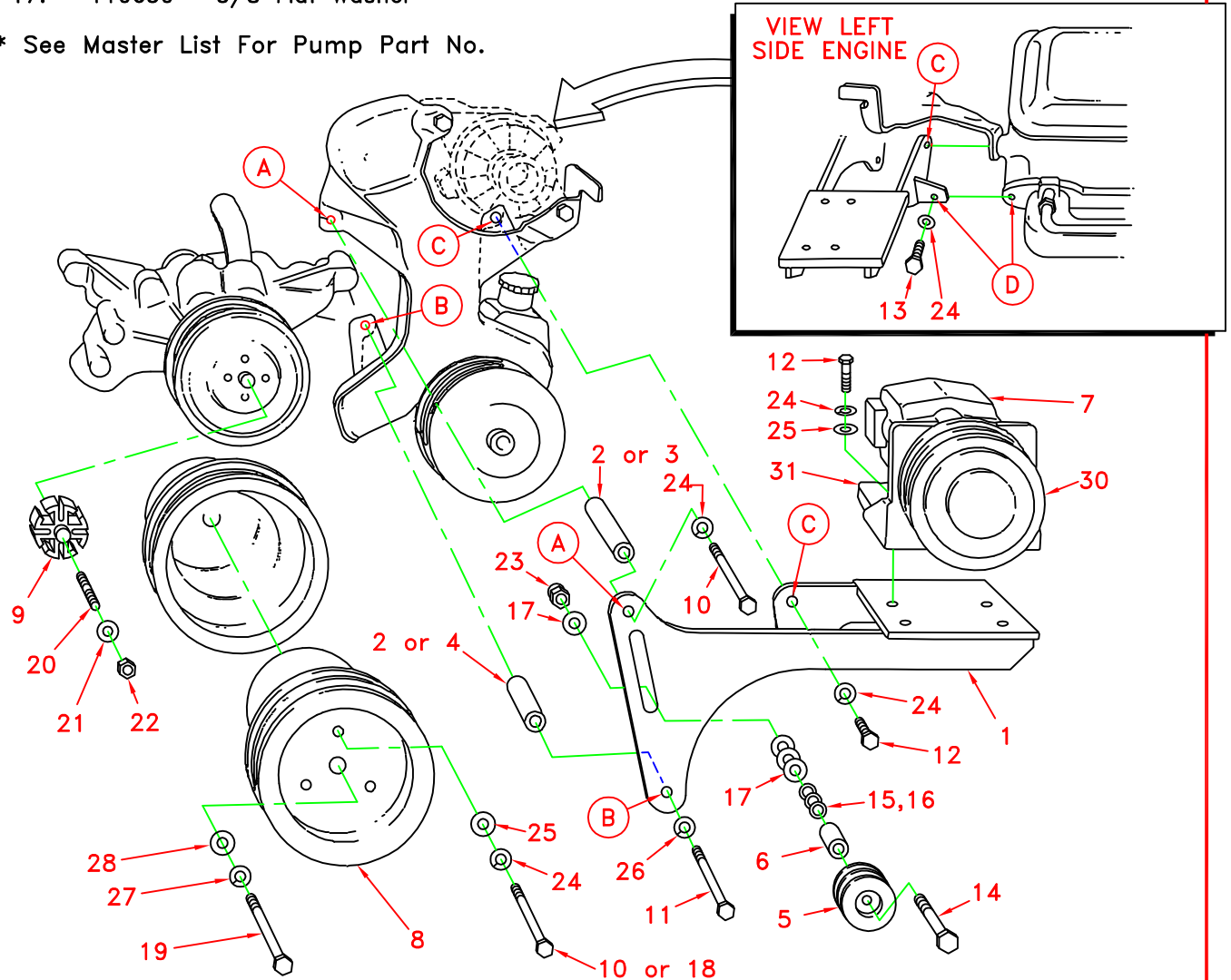

(A) Denotes bolt holes in engine to locate corresponding holes in Pump Brkt.

Chevy - 454  
1988-93 Serp. Belt  
Clutch Pump Kit #700014

INSTALLATION INSTRUCTIONS

NOTE: Suction hose to pump must be a wire braid hose; minimum 1" I.D. for 7 and 9 GPM pumps, 1 1/4" I.D. for 12 and 17 GPM pumps. Installation with smaller suction hoses will void the pump warranty.

1. Remove Fan and Shroud.
2. Remove OEM belt.
3. Remove OEM bolts in crankshaft pulley. Remove the 1/4" thick flat washer as this will not be used.

NOTE: Check the three 3/8" bolts removed from crankshaft pulley for Fine thread or Coarse Thread.

4. Install DewEze Crankshaft Pulley using one 1/2" X 6" NF bolt and three 3/8" X 5 3/4" Bolts; (8) if Coarse Thread, (16) if Fine Thread.
5. Remove OEM stud bolts in water pump pulley and install 8mm X 65mm Metric Stud Bolts (18). The short-thread end of Stud Bolts goes into water pump. You may need to cut the stud bolts shorter to allow room for the fan assembly to slide in between the radiator and end of stud bolts.
6. Place Fan Extension (7) over Stud Bolts. Fasten with flat washers and nuts on two Stud Bolts to hold in place during engine check run.
7. Remove OEM Belt tensioner.
8. Install Bracket (1).
  - A. Leave OEM Bolt in Hole B until bolts are installed in Holes A, C, and D. This will prevent the OEM bracket from slipping out of alignment.
  - B. Install 3/8" X 5 3/4" Bolt (8) at Hole A, using Spacer 2 (4.60") for '88-'91 trucks, Spacer 3 (4.54") for '92-'93 trucks.
  - C. Install 3/8" X 1 1/4" Bolt (10) at Hole C, and 3/8" X 1 1/2" Bolt (11) at Hole D.
  - D. Remove OEM bolt at Hole B. Install 7/16" X 6" Bolt (9) and Spacer 2 (4.60") for '88-'91 trucks, Spacer 4 (3.78") for '91-'92 trucks.
9. Reinstall OEM Belt and Tensioner.
10. Cut approximately 1/2" from end of top radiator hose to allow clearance for Clutch Pulley.
11. Install Pump and Clutch assembly (5) on bracket with the Belts (22) in place. Use straight edge to align Clutch Pulley with crankshaft pulley.

NOTE: Use A62 Belts with Standard Clutch, A61 Belts with Heavy Duty Clutch.

12. Install Idler Pulley (3), using 5/8" X 4" Bolt (12) and Lock Nut (21). Use Spacers (13,14,15) as needed to align Idler Pulley with belts.
13. Tighten belts. Run engine, checking for alignment and other installation problems.
14. Cut 1" off back side (away from radiator) of fan shroud.  
NOTE: This is important to improve air flow and prevent engine overheating.
15. Install Fan and Fan Shroud.
16. Run Engine, checking clearance, vibration, and alignment.