

DEWEZE

710048	Bracket Assy. (Inc. item 1)	Clutch Pump Kit	700069
710727	Bracket Bolt Pkg. (Inc. items 7-10,18,27,28,30)	Make	Dodge
710450	Pulley Bolt Pkg. (Inc. items 5, 6)	Engine Size	5.9L
710355	Idler Bolt Pkg. (Inc. items 13-17)	Fuel	Diesel
None	Fan Spacer Bolt Pkg.	Year	1992.5-93
		Options	H.D. Water Pump Turbo, Intercooled
		Revised	7-15-93

ITEM	QUAN	PART #	DESCRIPTION
1.	1.	710048	Pump mounting bracket
2.	1	710353	Foot Mount
3.	1	*	Pump
4.	1	740122	Engine Pulley
5.	6	110484	6mm x 16mm x 1.0 thd. bolt
6.	6	110667	1/4 Lock washer
7.	3	110479	10mm x 30mm x 1.5 thd. bolt
8.	3	110671	7/16 Lock washer
9.	1	110480	12mm x 45mm x 1.5 thd. bolt
10.	1	110666	1/2 Lock washer
11.	1	700142	Fan Spacer
12.	1	740040	Idler Pulley
13.	2	110668	5/8" Machine bushing (10 ga.)
14.	2	110669	5/8" Machine bushing (14 ga.)
15.	4	110650	5/8" Flat washer
16.	1	110477	5/8" X 3" NC Bolt
17.	1	110639	5/8" Lock Nut
18.	4	110425	3/8 x 1-1/4 NC Bolt
19.	1	OEM	Oil fill cap
20.	1	OEM	Gasket
21.	1	710379	Valve cover
22.	1	OEM	Bolt
23.	1	710380	Cover, fill tube
24.	1	OEM	O-Ring
25.	1	OEM	Gasket
26.	2	740050	V-Belt, Gates A50
27.	4	110672	3/8 Lock washer
28.	4	110676	3/8 Flat washer
29.	1	740037	Clutch, standard
		740038	Clutch, heavy duty
30.	1	110658	1/2 Flat washer

* See Master List for Pump Part No.

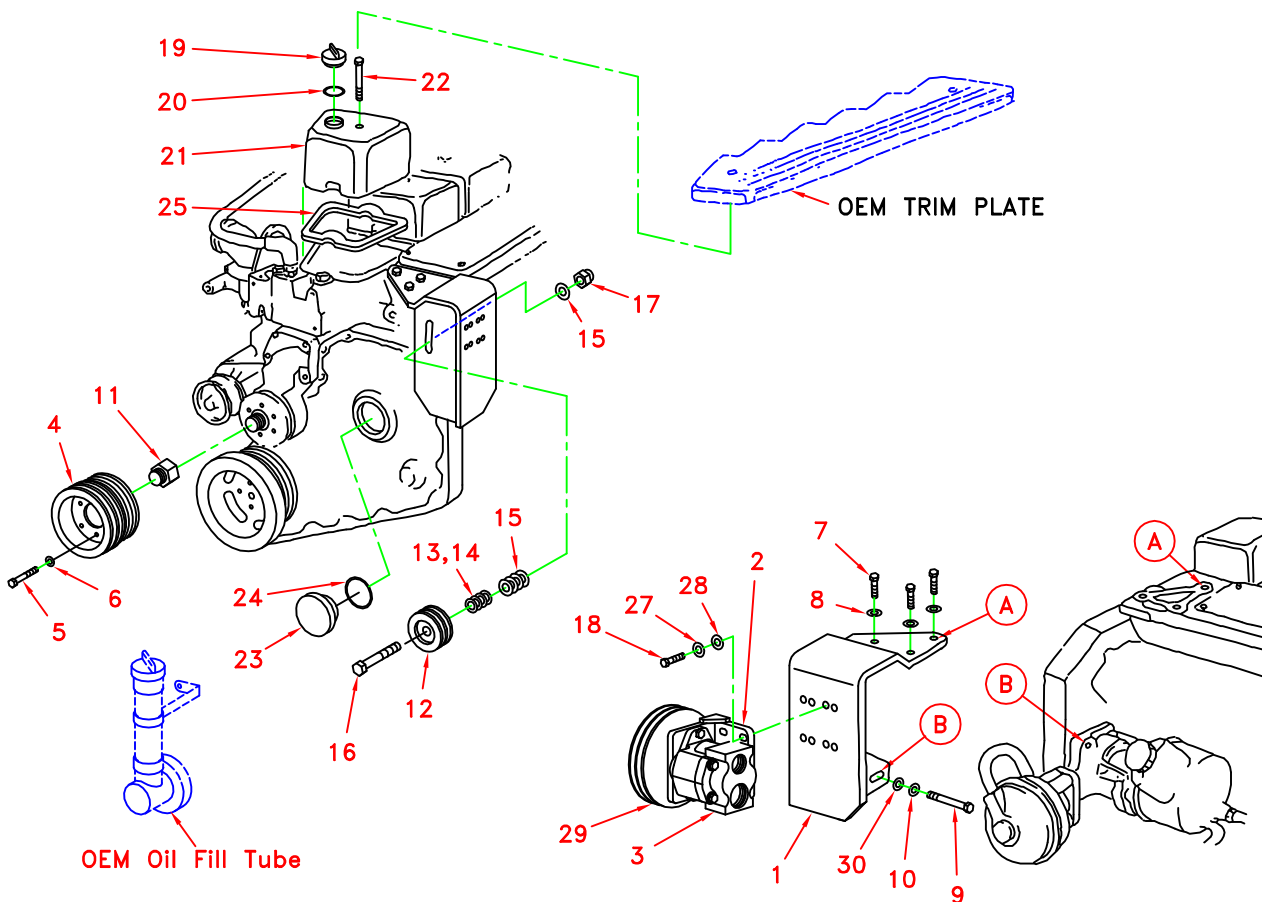

Ⓐ Denotes bolt holes in engine to locate corresponding holes in Pump Brkt.

RADIATOR MODIFICATION

1. Remove two bolts (1) in each bracket (2) holding top of radiator.
2. Elongate holes in bracket approximately 1/2" to rear. Cut off corner of bracket as shown.
3. Cut flange on rubber donut (3) as shown.
4. Bend sheet metal flange (4) in front of radiator to outside as shown.
5. Pull radiator toward grill.
6. Reinstall brackets and donuts and tighten bolts.

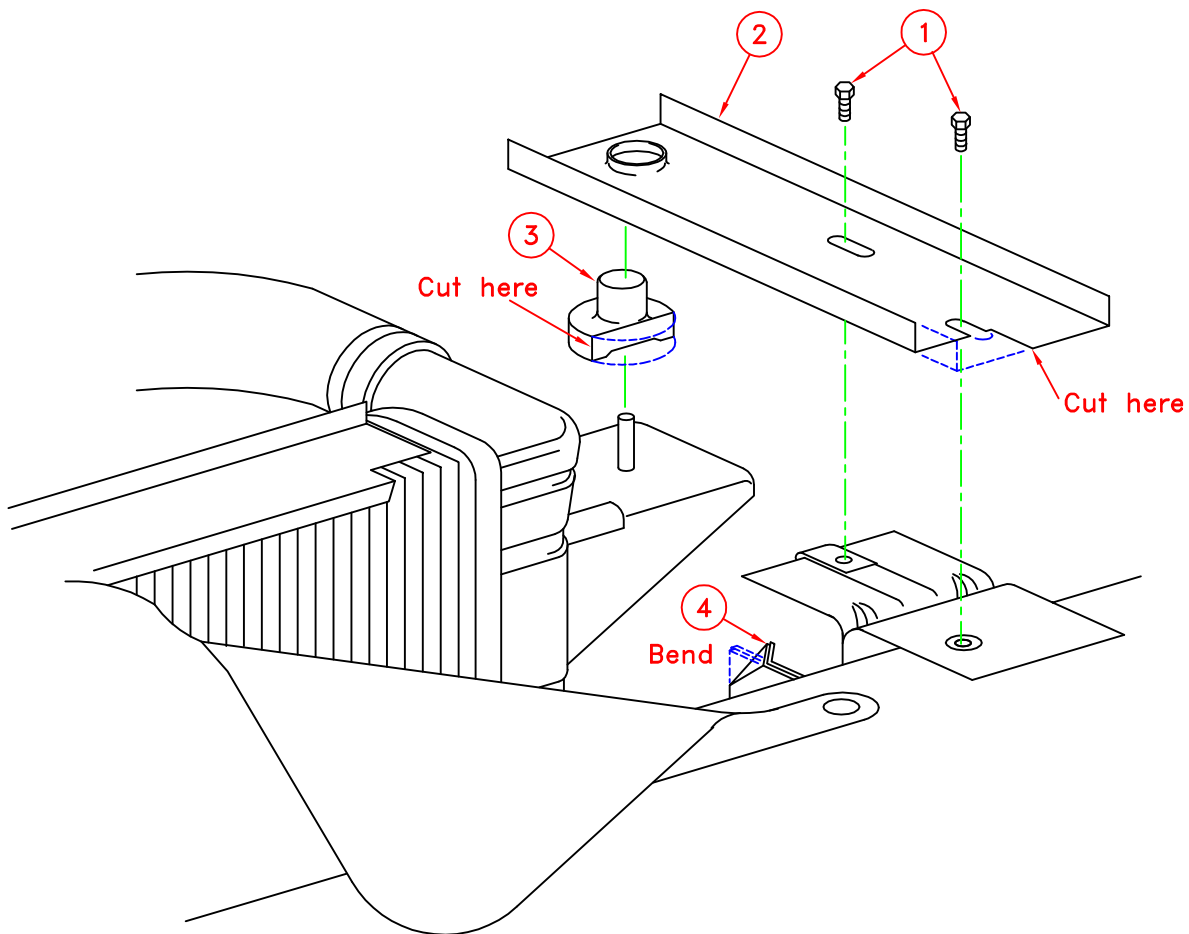

Dodge 5.9L Diesel
Turbo Intercooled
1992.5-93
Clutch Pump Kit #700069

INSTALLATION INSTRUCTIONS

NOTE: Suction hose to pump must be a wire braid hose; minimum 1" I.D. for 7 and 9 GPM pumps, 1 1/4" I.D. for 12 and 17 GPM pumps. Installation with smaller suction hoses will void the pump warranty.

1. Remove fan and shroud.
2. Move radiator forward per illustration.
3. Loosen the battery hold-down bracket and move battery toward fender as far as possible to allow clearance for the clutch pulley. Retighten hold-down.
4. Remove OEM oil fill tube from front of engine. Save OEM O-Ring (24).
5. Place O-Ring (24) inside cover (23). Screw cover into hole.
6. Install fan spacer and tighten securely.
7. Loosen OEM serpentine belt.
8. Remove the six bolts holding the OEM fan pulley and remove the fan pulley from the engine.
9. Install the DewEze steel pulley with the six 6mm x 16mm bolts (5) and lock washers (6). Retighten serpentine belt.
10. Remove OEM 12mm bolt in hole B in drawing.
11. Lower bracket into position and start three 10mm bolts (7) location A, then start the 12 mm bolt (9) in location B.
12. Tighten the three 10mm bolts (7) first, then tighten the 12mm bolt (9).
13. Assemble the pump and clutch, then lower the pump into position on the bracket.
14. Start the four 3/8 x 1 1/4 bolts (18) with lock and flat washers that hold the pump assembly in place. Use the back set of threaded holes.
15. Align the clutch pulley with the drive pulley using straight edge and tighten the bolts when the pump assembly is in alignment.
16. Install the belts around the drive and clutch pulley.
17. Align the idler pulley with the drive and clutch pulley using the washers (13, 14, 15) as needed.
18. Tighten the belts using the idler and then tighten the center bolt in idler.

19. Remove OEM plastic trim plate from valve covers.
20. Remove OEM Front valve cover. Save gasket and keep in place. Install new valve cover (21) using OEM bolt (22).
21. Place seal (20) onto OEM oil fill cap (19) and screw into valve cover.
22. Run engine, checking for vibration, alignment, etc.
23. Shut off engine, install fan and shroud.
24. Cut the fan shroud to allow clearance for the clutch pulley.

—