

# DEWEZE

710056	Bracket Assy. (Inc. items 1,2)		Clutch Pump Kit	700072
710866	Bracket Bolt Pkg. (Inc. items 8-18)		Make	Chevy
710867	Pulley Bolt Pkg. (Inc. items 19-24)		Engine Size	454
None	Idler Bolt Pkg.		Fuel	Gas
700129	Fan Spacer Bolt Pkg. (Inc. item 25-27)		Year	1994
			Options	
			Revised	B 2-13-04

ITEM	PART #	DESCRIPTION
1.	710855	Engine Bracket
2.	710856	Pump Plate
3.	740138	Crank Pulley
4.	700128	Fan Spacer
5.	*	Pump
6.	740037	Clutch, Standard
	740038	Clutch, Heavy Duty
7.	711216	Footmount
8.	110535	7/16NC x 1 1/2 Bolt
9.	110670	7/16 Flat Washer
10.	110671	7/16 Lock Washer
11.	110429	1/2NC x 1 1/2 Bolt
12.	110615	1/2NC Lock Nut
13.	110588	1/2NC Wiz Nut
14.	110435	3/8NC x 1 1/2 Bolt
15.	110425	3/8NC x 1 1/4 Bolt
16.	110404	3/8NC x 1 3/4 Bolt
17.	110676	3/8 Flat Washer
18.	110672	3/8 Lock Washer
19.	110549	1/2NF x 6 Bolt
20.	110658	1/2 Flat Washer
21.	110666	1/2 Lock Washer
22.	110133	3/8NF x 5 1/4 Bolt
23.	110110	8mm X 55mm X 1.25 Stud
24.	110643	8mm X 1.25 Nut
25.	110674	5/16 Lock Washer
26.	740058	V-Belt, A62

\* See Master List for Pump Part No.

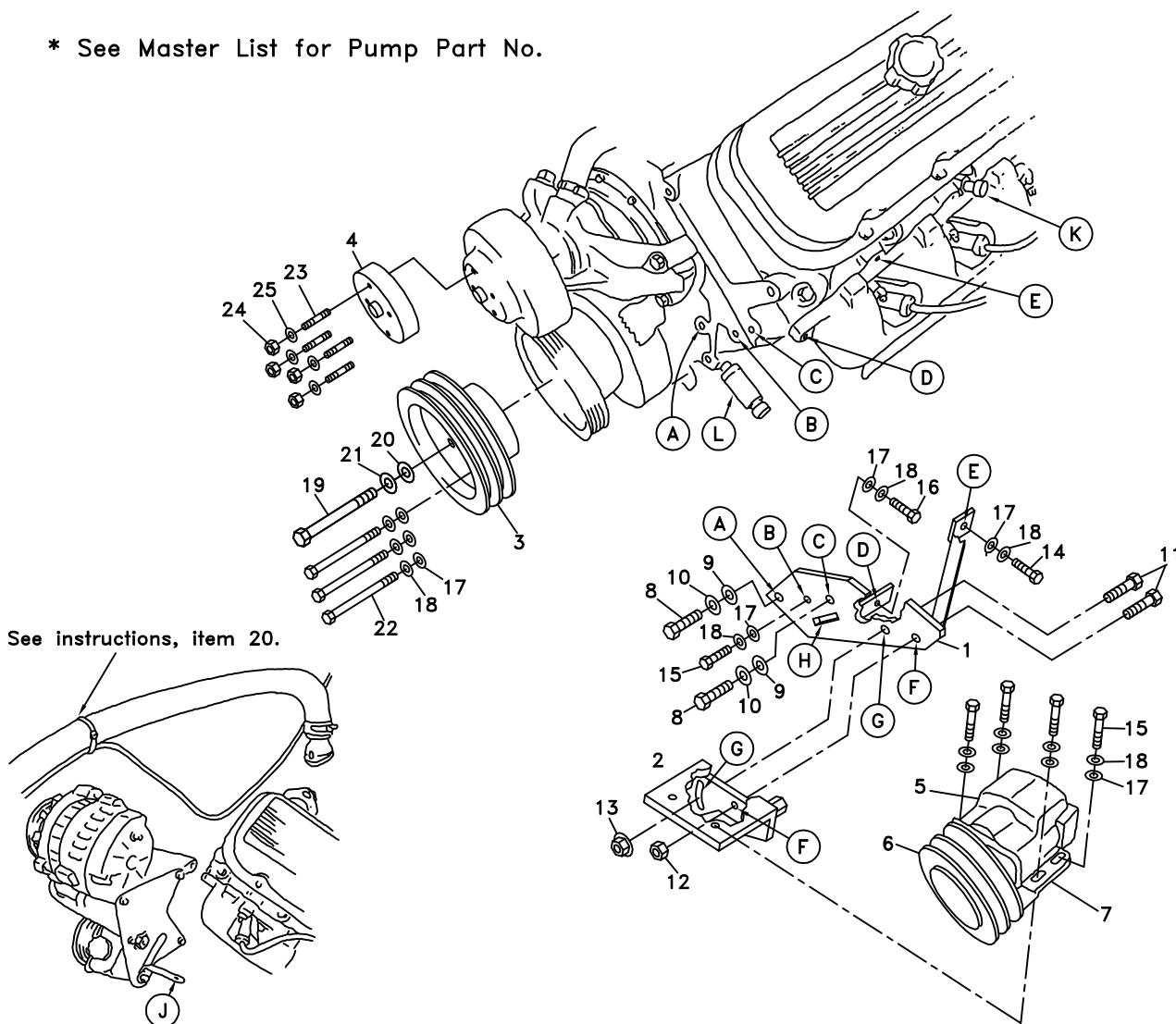

Ⓐ Denotes bolt holes in engine to locate corresponding holes in Pump Brkt.

Chevy 454  
1994  
Clutch Pump Kit #700072

INSTALLATION INSTRUCTIONS

NOTE: Suction hose to pump must be a wire braid hose; minimum 1" I.D. for 7 & 9 GPM pumps, 1 1/4" I.D. for 12 & 17 GPM pumps. Installations with smaller suction hoses will void the pump warranty.

1. Disconnect battery.
2. Remove top half of fan shroud. Remove fan.
3. Remove OEM serpentine belt.
4. Disconnect wires from alternator.
5. Unplug wire to heat sending unit (location K). Unplug wire to oil pressure sending unit (location L).
6. Remove power steering pump return line at brake booster.
7. Remove bolts - three on front and one on lower left of engine - attaching alternator/power steering pump to engine. Slide alternator/power steering bracket forward.
8. Remove front exhaust manifold bolt (hole D).
9. Slide DewEze bracket (1) into place. Attach with:  
7/16 x 1 1/2 bolt (8), Lock and flat washer at hole A and C.  
3/8 x 1 1/4 bolt (15), Lock and flat washer at hole B.  
3/8 x 1 3/4 bolt (16), Lock and flat washer at hole D.  
3/8 x 1 1/2 bolt (14), Lock and flat washer at hole E.
10. Replace OEM Alt./Power Steering Bracket. Tab J goes through slot H in DewEze Bracket.
11. Replace OEM serpentine belt.
12. Remove OEM bolts from crankshaft pulley. Place DewEze crank pulley (3) into OEM pulley with one 1/2 x 6 NF bolt (19) with lock and flat washers and three 3/8 x 5 3/4 NF bolts (22) with lock and flat washers.
13. Remove OEM stud bolts in water pump pulley. Place the short threaded end of the four 8mm x 55mm studs (23) into the pulley.
14. Slide the fan spacer (4) over the stud bolts and temporarily secure in place with two lock washers (25) and two nuts (24).
15. Attach pump mounting plate (2) to engine bracket (1) at hole F with a 1/2 x 1 1/2 bolt (11) and 1/2 lock nut (12), at hole G use a 1/2 x 1 1/2 bolt and a 1/2 wiz flange nut (13). Tighten these nuts.
16. Assemble pump (5) onto foot mount (7) and clutch (6) onto pump. Attach pump assembly onto pump mounting plate (2) with

four 3/8 x 1 1/4 bolts (15) and lock and flat washers. Do not tighten yet.

17. Install the two V-belts (26).
18. Align the clutch pulley with the crankshaft pulley by placing a straight edge across the face of both pulleys. Tighten the four bolts holding the pump assembly on.
19. Loosen the 1/2" nuts holding the pump bracket on just enough to allow the pump bracket to pivot. Tighten the V-belts by placing a breakover bar with a 7/8 socket on the hex lug on the rear of the pump bracket. Tighten the 1/2" nuts.
20. Tie the small plastic line from the fuel cannister to the upper radiator hose for clearance from fan and belts.
21. Run the engine checking for any installation or alignment problems. Adjust as needed.
22. Remove the two nuts holding the fan spacer on. Replace the fan and secure with all four nuts and lock washers. Replace fan shroud.
23. Run engine again checking for clearance, vibration, and alignment. Retighten belts if needed.

—