

-----	Bracket Assy. (See item 1)		Kit No.	700325
711125	Bracket Bolt Pkg. (Inc. item 2)		Make	Ford
None	Pulley Bolt Pkg.		Engine	7.3L
None	Idler Bolt Pkg.		Fuel	Diesel
None	Fan Spacer Bolt Pkg.		Year	1996-1999
			Equipment	w/o A/C
			Revised	A 6-10-99

ITEM	PART #	DESCRIPTION
1.	710082	Pump mount plate
2.	110486	8mm x 30mm Bolt
3.	110425	3/8NC x 1 1/4 Bolt
4.	110672	3/8 Lock washer
5.	*	Pump
6.	740148	Clutch, serpentine
7.	740249	Idler pulley/2.50" Dia., w/one bearing

FIG. 1
1999

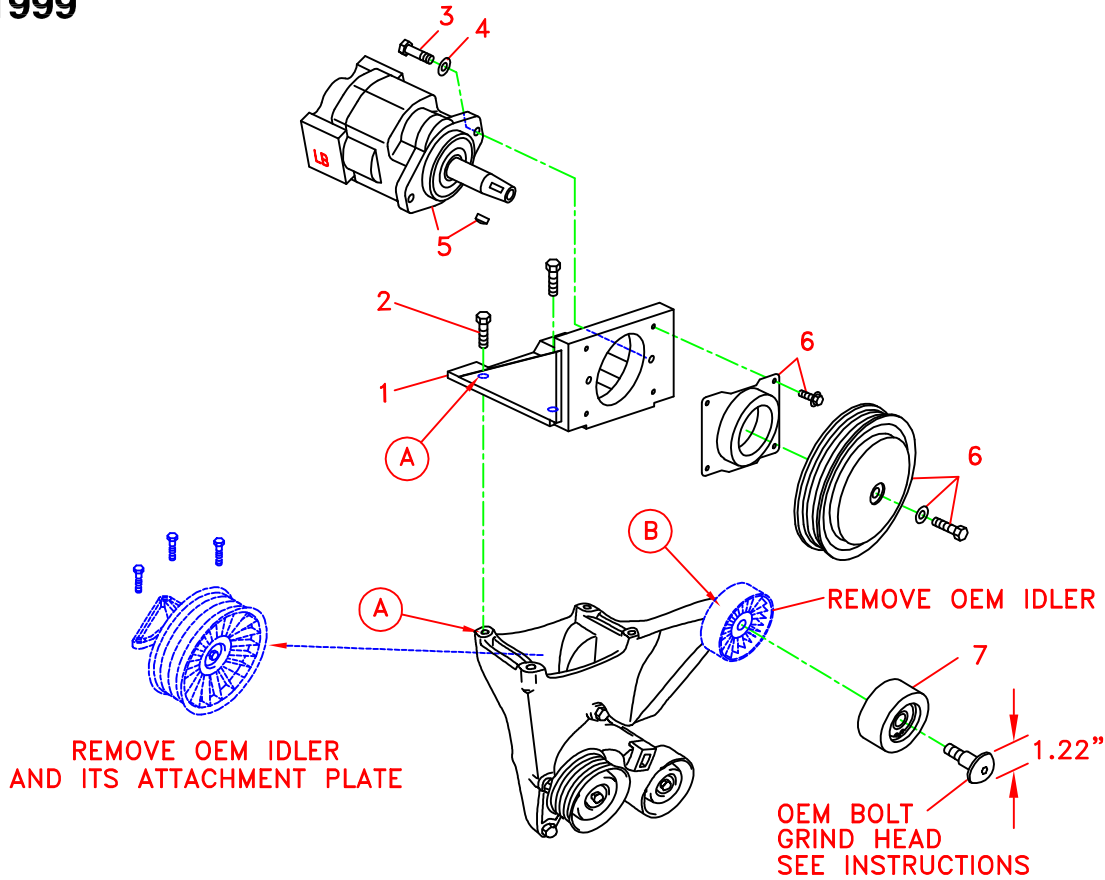

(A),(B),(C)... Denotes bolt holes in engine to locate corresponding holes in Pump Brkt.

FIG. 2
1999

BELT DIAGRAM

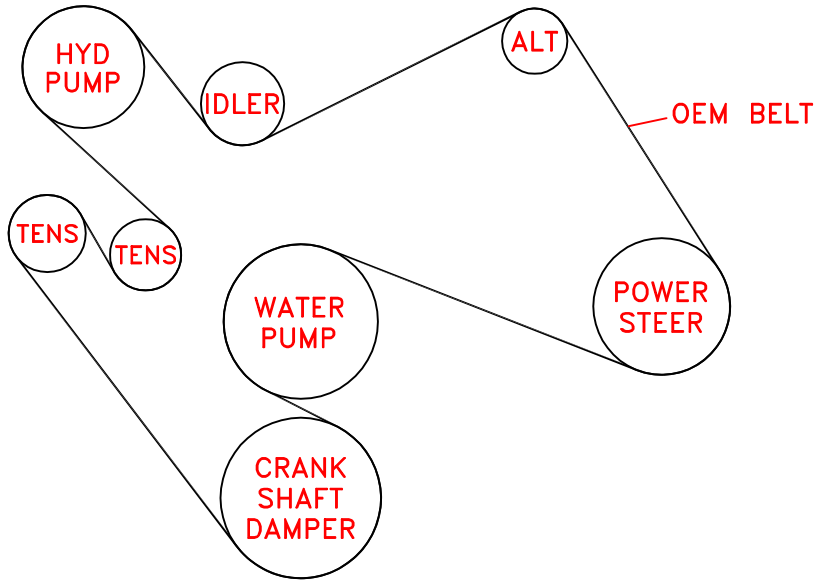

FIG. 3
1996-1998

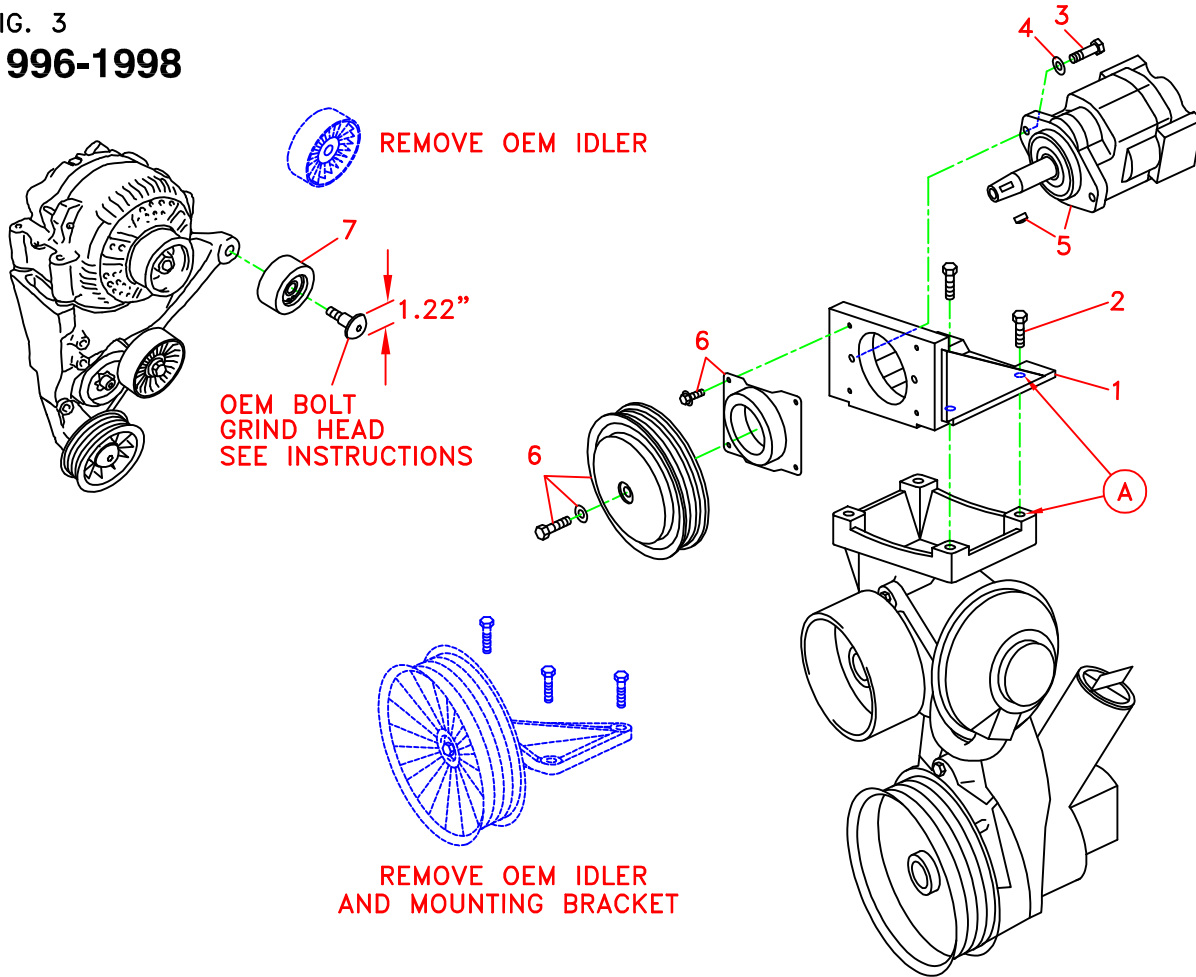
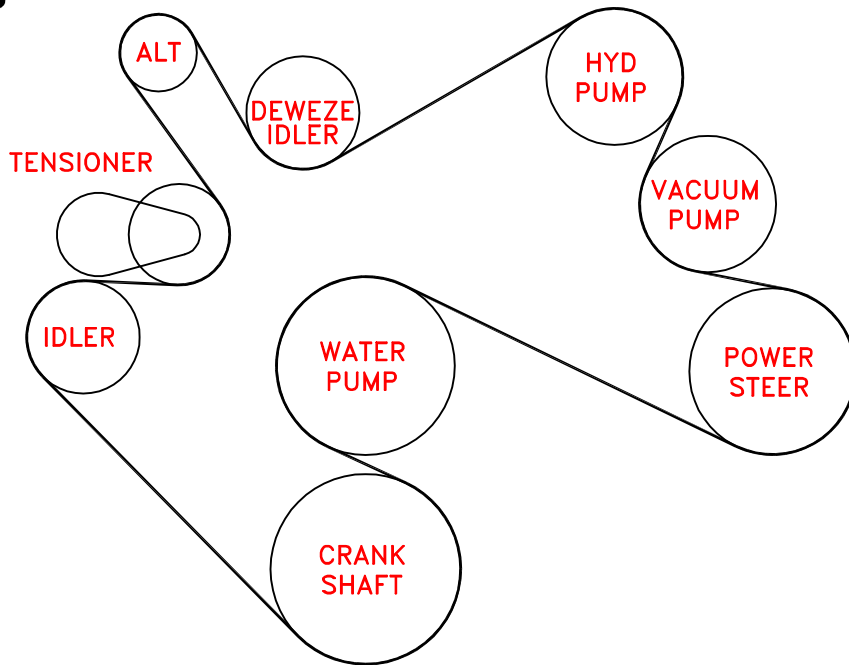

FIG. 4
1996-1998

BELT DIAGRAM



DewEze

Clutch Pump Kit
#700325
Ford 7.3L
Without A/C
1996-99

INSTALLATION INSTRUCTIONS

NOTE: Suction hose to pump must be a wire braid hose; minimum 1" I.D. for 7 & 9 GPM pumps; 1¼" I.D. for 12 & 17 GPM pumps. Installations with smaller suction hoses will void the pump warranty.

NOTE: The following instructions are for the model year 1999. Refer to Fig. 1 and 2.

1. Disconnect battery.
2. Remove OEM serpentine belt.
3. Remove OEM idler and its attachment plate from top of air conditioning bracket by removing three bolts on top at Location A.
4. Remove OEM idler pulley from front of air conditioning bracket at Location B. Keep the bolt.
5. Turn down or grind head of OEM idler bolt to 1.22" dia. This is to allow the bolt head to fit inside the snap ring in the idler pulley.
6. At the same location you removed the OEM idler, install the DewEze idler pulley (7) with the snap ring facing forward, away from the engine. Use the OEM bolt that has been turned down.
7. Bolt on pump mounting plate (1) using four 8mm x 30mm (2) in holes A at top of OEM air conditioner bracket.
8. Bolt pump to plate using two 3/8 x 1¼ bolts (3) and two 3/8 lock washers (4).
9. Bolt clutch coil (6) to front of plate using four wiz flange bolts supplied with clutch.
10. Bolt clutch pulley to pump shaft with bolt and heavy washer supplied with clutch.
11. Install OEM belt as shown in Fig. 2.
12. Reconnect the battery.
13. Run the engine and check for any clearance or alignment problems.

Clutch Pump Kit
#700325
Ford 7.3L
Without A/C

NOTE: The following instructions are for model years 1996 to 1998. Refer to Fig. 3 and 4.

1. Disconnect battery.
 2. Remove OEM serpentine belt.
 3. Remove OEM idler mounting bracket from top of air conditioning/power steering bracket.
 4. Remove OEM idler pulley from alternator bracket.
 5. Turn down or grind head of OEM idler bolt to 1.22" dia. This is to allow the bolt head to fit inside the snap ring in the idler pulley.
 6. At the same location you removed the OEM idler, install the DewEze idler pulley (7) with the snap ring facing forward, away from the engine. Use the OEM bolt that has been turned down.
 7. Bolt on pump mounting plate (1) using four 8mm x 30mm (2) in holes A at top of OEM air conditioner bracket.
 8. Bolt pump to plate using two 3/8 x 1 1/4 bolts (3) and two 3/8 lock washers (4).
 9. Bolt clutch coil (6) to front of plate using four wiz flange bolts supplied with clutch.
 10. Bolt clutch pulley to pump shaft with bolt and heavy washer supplied with clutch.
 11. Install OEM belt as shown in Fig. 4.
 12. Reconnect the battery.
 13. Run the engine and check for any clearance or alignment problems. Adjust as needed.
-