

# DewEze CLUTCH PUMP KIT

None	Bracket Assy.	Kit No.	700368
711327	Bracket Bolt Pkg. (Inc. items 7, 8, 10, 14)	Make	Ford
None	Pulley Bolt Pkg.	Engine	7.3L
None	Idler Bolt Pkg.	Fuel	Diesel
None	Fan Spacer Bolt Pkg.	Year	1999
		Equipment	w/AC
		Revised	F 10-3-11

ITEM	PART #	DESCRIPTION
1.	711324	Pump mounting bracket
2.	740261	Flat idler pulley
3.	-----	-----
4.	OEM	Flat idler pulley
5.	*	Pump
6.	740183	Clutch
7.	710387	M10 x 95 x 1.5 Bolt
8.	110270	M8 x 130 x 1.25 Bolt
9.	540039	3/8-16 x 1 1/4 Skt head bolt
10.	710492	1/4-20 X 1/2 Bolt
11.	110213	M10 x 40 x 1.5 Shoulder Bolt
12.	OEM	Bolt
13.	-----	-----
14.	130011	Adel clamp
15.	110271	3/8 Lock washer, .55 O.D. x .13 thick
16.	740277	Belt/Dayco 5081265

\* See master list for pump part no.

FIG. 1  
BELT DIAGRAM

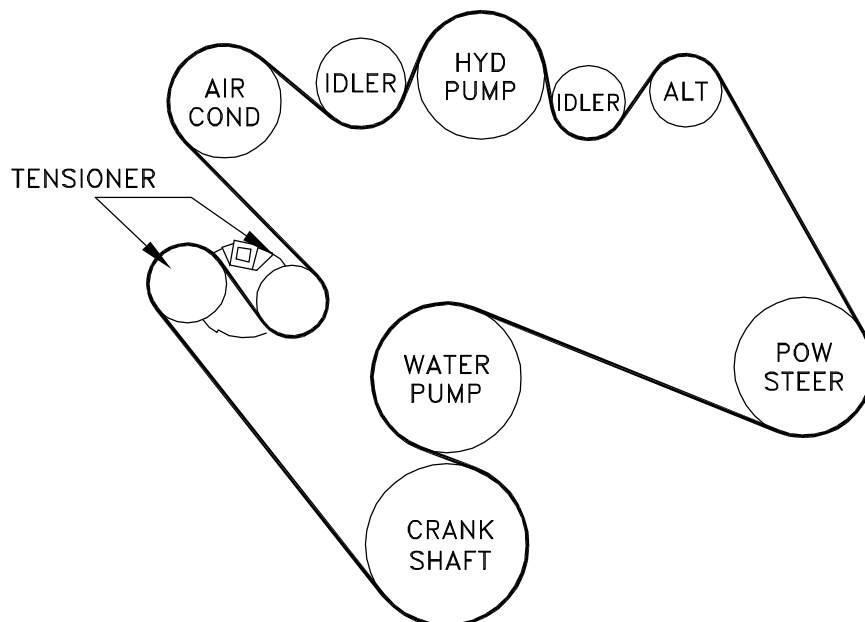

(A),(B),(C)... Denotes bolt holes in engine to locate corresponding holes in Pump Brkt.

FIG. 2

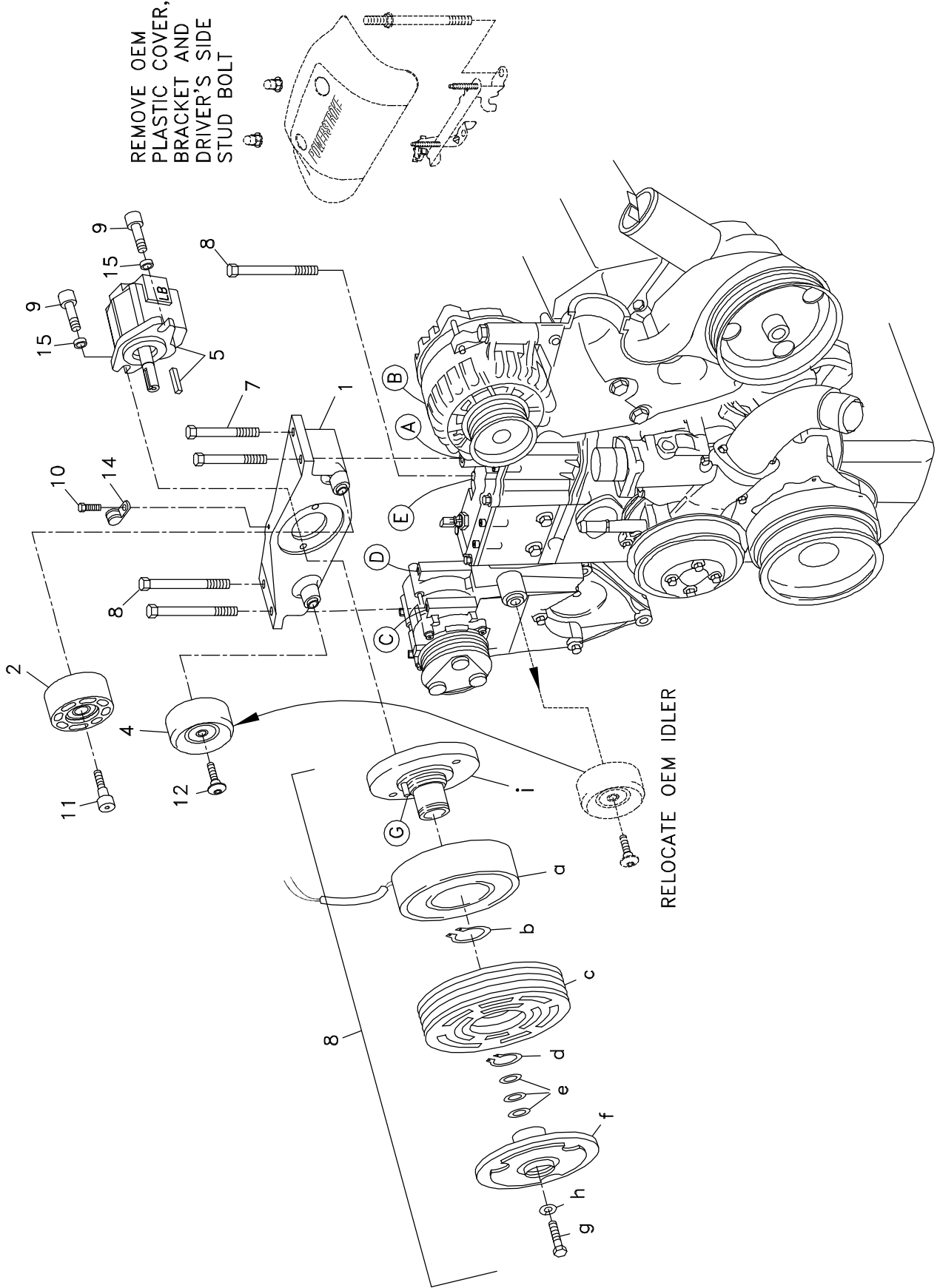

# DewEze

Clutch Pump Kit  
#700368  
Ford 7.3L  
with A/C  
'AA' mount  
2000

## INSTALLATION INSTRUCTIONS

1. Disconnect the battery.
2. Drain the radiator so the coolant level is below the top radiator hose. Remove the end of the hose from the radiator only.
3. Lock the OEM tensioner open and remove the OEM belt.
4. Remove the OEM plastic cover and its mounting bracket from between the A/C and the alternator. Remove the driver's side stud bolt at location E that is used to mount that bracket. Replace it with one of the M8 x 130 bolts (8). Torque to 14 ft-lb.
5. Remove the OEM idler (4) from the A/C bracket and mount it using the OEM bolt on the passenger side boss on the DewEze pump bracket (1). Torque to 25 ft-lb.
6. Insert the M10 x 40 bolt (11) into the DewEze idler (2) and thread into the boss on the driver's side of the pump bracket (1). Torque to 25 ft-lb.
7. Hold pump (5) onto back of bracket (1) and clutch hub (8i) onto front of bracket, making sure anti-rotation pin (G) on front of hub is on top. Place two 3/8 x 1 1/4 socket head bolts (9) and 3/8 flat washers (15) through pump, through mounting plate and thread into hub. Torque to 20 ft-lb.
8. Slide coil (8a) over hub, aligning hole in the back plate of coil with the anti-rotation pin (G) in the hub. The wires from the coil should be on the same side as the pin (G). Install large snap ring (8b) to hold coil in place.  
**NOTE: THE BEVEL ON BOTH SNAP RINGS MUST FACE AWAY FROM THE PUMP. REFER TO INSTRUCTION SHEET FOR THE CLUTCH FOR CORRECT INSTALLATION OF SNAP RINGS.**
9. Slide clutch pulley (8c) onto hub. Install small snap ring (8d) to hold pulley in place.
10. Place the key (5) onto the pump shaft. Slide the hub/armature (8f) onto the pump shaft.  
**NOTE: SET THE AIR GAP BETWEEN THE HUB/ARMATURE AND THE PULLEY USING SHIMS (8e) ACCORDING TO INSTRUCTION SHEET FOR CLUTCH.**
11. Thread bolt (8g) and lock washer (8h) into pump shaft. Torque to value in clutch instruction sheet.
12. Place the Adel clamp (14) over the clutch wire and bolt to the top of the pump bracket with the 1/4 x 1/2 bolt (10), keeping the wire snug so it does not contact the pulley.
13. Install the fittings on the pump.
14. Set the pump bracket with pump and idlers into place on the air conditioner and alternator. Thread the M10 x 95 bolts (7) through the bracket and into the alternator at locations A and B. Torque to 25 ft-lb. Thread the M8 x 130 bolts (8) through the bracket and into the air conditioner. Torque to 14 ft-lb.
15. Install the serpentine pump drive belt (16) per diagram. Attach the top radiator hose. Replace the coolant in the radiator.
16. Connect the battery.
17. Run the engine and check for any clearance or alignment problems. Adjust as needed.