

Bracket Assy.	711423
Bolt Packages:	
Bracket	711424 (Inc. items 10, 11, 17, 20-22)
Pulley	None
Idler	None
Tensioner	None

Make	International
Engine	DT466
Fuel	Diesel
Year	2002-
Equipment	Turbo, A/C
Revised	A 5-1-02

Item	Part No.	Description
1.	711401	Pump mount bracket
2.	711412	Pump plate
3.	711413	Brace / alternator
4.	740261	Idler
5.	120132	90° adapter
6.	*	Pump / rear port
7.	740148	Clutch
8.	OEM	Alternator
9.	OEM	Bolt
10.	110244	1/2-13 x 1 1/2 Skt hd bolt
11.	110403	1/2-13 x 2 1/2 Bolt
12.	OEM	Bolt
13.	OEM	Nut
14.	110213	M10 x 1.5 x 40 Shoulder bolt
15.	110425	3/8-16 x 1 1/4 Bolt
16.	110676	3/8 Flat washer
17.	110615	1/2-13 Lock nut
18.	220115	1/2 - 3/8 Reducer bushing
19.	120082	3/8 Pipe plug
20.	110379	1/2-13 x 2 Bolt
21.	130011	Adel clamp
22.	110515	1/4-20 x 1/2 Bolt
23.	740246	Belt/Micro-V K080825

FIG. 1

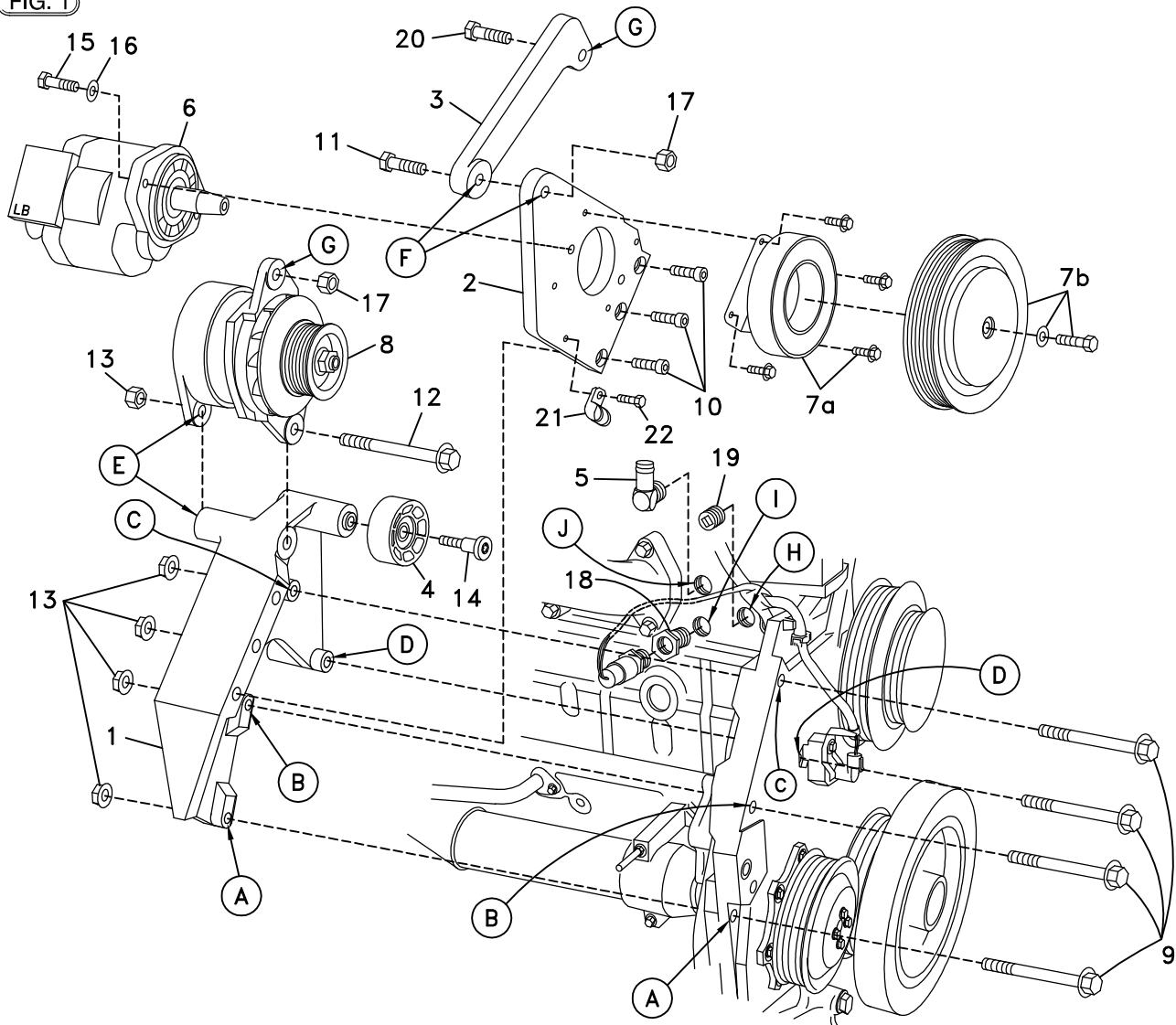

(A),(B),(C)... Denotes bolt holes in engine to locate corresponding holes in Pump Brkt.

FIG. 2
BELT DIAGRAM

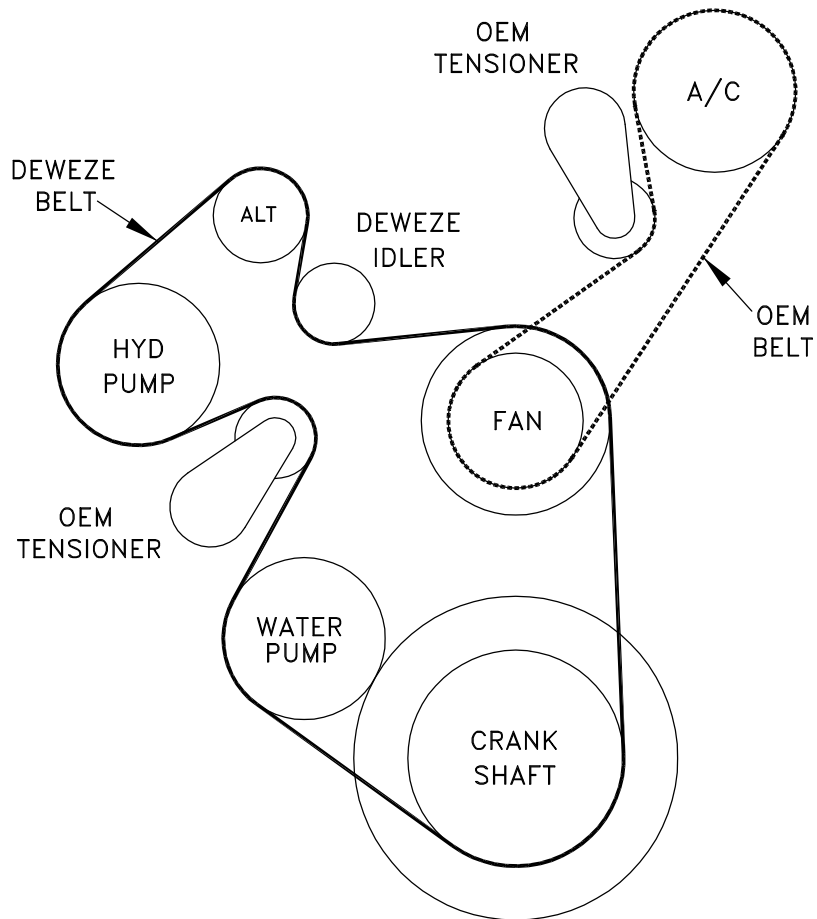
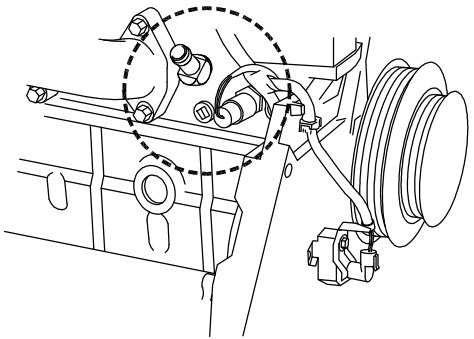
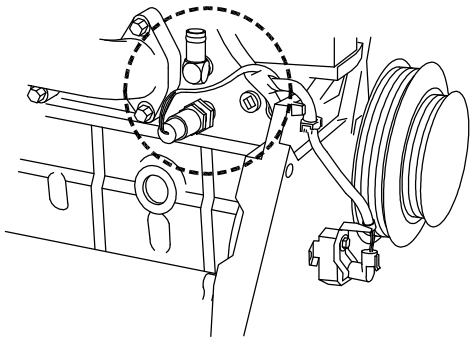

FIG. 3
OEM CONFIG.



CONFIG. AFTER MODIFICATION



DewEze

Clutch Pump Kit

Clutch Pump Kit
700393
International
DT466
'A' mount
2002-

INSTALLATION INSTRUCTIONS

1. Disconnect the battery.
2. Drain the radiator down so the heater hose and the temperature sender can be removed.
3. Remove the alternator by removing two bolts and nuts. Remove the alternator bracket by removing four bolts and nuts.

NOTE: Put thread sealer on all the pipe threads in items 3 and 4 that are installed into the engine.
4. Remove the heater hose from the OEM 45° adapter at Location J. Remove the 45° adapter. Replace it with the 90° adapter (5). Replace the hose and clamp.
5. Remove the OEM plug at location I. Thread the reducer bushing (18) into the hole at Location I. Remove the temperature sensor from Location H. Slit open the wiring harness to pull out more of the sensor wires so it will stretch to Location I. Thread the sensor into the reducer at Location I. Thread the 3/8 pipe plug (19) into Location H.
6. Install the idler pulley (4) onto the boss on the DewEze alternator/pump bracket (1) using the M10 x 40 shoulder bolt (14).
7. Bolt the DewEze alternator and pump bracket (1) where the OEM alternator bracket was at Locations A, B, C, and D using the OEM bolts (9) and nuts (13). Attach the alternator to the bracket at Location E using the OEM bolt (12) and nut (13).
8. Bolt the pump (6) to the back of the pump plate (2) with two 3/8 x 1 1/4 bolts (15) and two 3/8 flat washers (16). Bolt the pump plate (2) to the alternator bracket using three 1/2 x 1 1/2 socket head bolts (10). Bolt the clutch coil (7a) to the front of the pump plate with four 1/4 x 1/2 flange bolts. Bolt the clutch pulley (7b) to the pump shaft with the 5/16 x 1 1/4 bolt and heavy washer.
9. Attach the alternator brace (3) to the top hole on the pump plate with a 1/2 x 2 1/2 bolt (11) and a 1/2 lock nut (17). Attach the other end of the brace to the top of the alternator at Location G with a 1/2 x 1 1/2 bolt (11) and a 1/2 lock nut.
10. Place the belt (20) on the pulleys as shown in Fig. 2.
11. Replace the coolant in the radiator. Reconnect the battery.
12. Run the engine and check for any clearance or alignment problems. Adjust as needed.