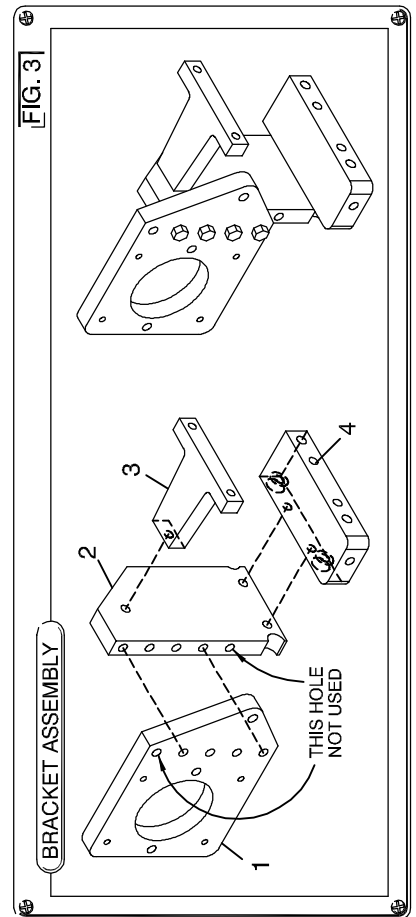

**FIG. 2**



**FIG. 3**

**BRACKET ASSEMBLY**

# DewEze Clutch Pump Kit 700506

Ford F-650,-750, Cat 3126, 2009+

## INSTALLATION INSTRUCTIONS

1. The installation of this kit requires trained decision-making concerning clearances, tying components together, rerouting, or relocating OEM components, etc. It is impossible to describe all of the clearance and vibration points, etc. in the installation instructions. Therefore, the technician must exercise professional judgment to achieve the best quality installation.
2. Disconnect the battery.
3. Remove the intercooler tube on the passenger side.
4. Remove the OEM belt.
5. Remove the top two air conditioner compressor bolts at Location A along with the hose clamp bracket. Mount the DewEze A/C bracket (3) at that location loosely threading one M8 x 120 bolt (11) with Loctite® in the front hole. The A/C line may need to be pulled out a little bit and the plastic clamp turned around to fit. Hold the OEM clamp bracket (18) in place over the rear hole of the DewEze bracket (3) and loosely thread the other M8 x 120 bolt in with Loctite®. Do not tighten bolts until all brackets are in place.
6. Remove the top alternator bolts at Location B. Mount the alternator spacer (4) at that location using two M10 x 140 socket head bolts (12) with Loctite®. Do not tighten the bolts yet.
7. Mount the bridge plate (2) onto bracket (3) and spacer (4) with three 3/8 x 1 1/2 bolts (10) with Loctite®. Now tighten all bolts in brackets 2, 3, and 4.
8. Bolt the pump (8) onto the pump plate (1) using two 3/8 x 1 1/4 bolts (15), two 3/8 lock washers (16), and two 3/8 flat washers (17). Mount the clutch coil (9a) using the four 1/4 x 1/2 flange bolts (9b) supplied with the clutch.
9. Using the second hole from the top, attach the pump plate (1) with pump to the top hole in the bridge plate (2) at Location C using four 3/8 x 1 1/2 bolts (10) with Loctite®.
10. Insert idler bushing (5) (flange thickness of .775") into idler (7). Mount this idler to pump plate (1) with the M10 x 60 bolt (13) with Loctite® and a 3/8 flat washer (17).
11. Insert idler bushing (6) (flange thickness of .350") into idler (7). Mount this idler to alternator spacer (4) with the M10 x 50 bolt (14) with Loctite® and a 3/8 flat washer (17).
12. Mount the pump pulley (9c) to the pump shaft with the 5/16 x 1 1/4 bolt (9d) and heavy flat washer (9e) supplied with the clutch.
13. Install the belt (19) as shown in the diagram (Fig. 1).
14. Before installing the intercooler tube, .75" will need to be cut off the turbo side of the orange hose. This will lower the tube so it will clear the pump.
15. Run the engine and check for any clearance or alignment problems. Adjust as needed.