

Isuzu NPR :D, 2009+, B Pump

Bolt Packages:

Bracket	716035 (Inc. item 10, 19-23, 29-34, 36-38, 40, 41, 43, 52)
Crank pulley	711725 (Inc. item 24, 35)
Pump pulley	711726 (Inc. item 26, 42)
Fan spacer	716036 (Inc. item 25)
Idler/Tensioner	711728 (Inc. item 11, 27, 41, 46)

Issue Date	1-11-10	Revision Date	2-9-11
------------	---------	---------------	--------

Item	Part No.	Description
1.	716026	Pump plate mount
2.	716027	Lower engine bracket
3.	716028	Brace, pump bracket
4.	711716	Spacer block
5.	711717	Tensioner plate
6.	716029	Block, fan shroud
7.	716030	Rear pump support
8.	OEM	Fan shroud bracket
9.	716031	Dipstick bracket
10.	716032	Spacer, fan shroud
11.	711723	Idler bushing
12.	700280	Fan spacer
13.	740393	Tensioner
14.	740426	Crank pulley
15.	740395	Pump pulley
16.	510241	QD bushing
17.	740261	Idler
18.	700281	Hose
19.	110100	M10 x 52 Stud
20.	110404	3/8 x 1 3/4 Bolt
21.	110580	M10 x 85 Bolt
22.	110745	3/8 x 1.5 Bolt
23.	110417	1/2 x 1.5 Bolt
24.	110314	M16 x 80 Bolt
25.	110923	M8 x 45 Bolt
26.	110464	1/4 x 1 Bolt
27.	110262	M10 x 75 Bolt
28.	OEM	Pump bolts
29.	110282	M10 x 20 Hex head bolt
30.	110265	M10 Flange nut
31.	710586	1/4 x 1 Self tap screw
32.	130011	Adel clamp, AC6
33.	110925	M8 x 40 Flange head bolt
34.	520099	Hose clamp, .75"
35.	110669	.625 x 1.00 x 14 Ga. Washer
36.	110672	3/8 Lock washer
37.	110727	Adel clamp, AC12
38.	110671	7/16 Lock washer
39.	-----	-----
40.	110666	1/2 Lock washer
41.	110658	1/2 Flat washer
42.	110667	1/4 Lock washer
43.	110703	M8 Flat washer
44.	-----	-----
45.	-----	-----
46.	110577	M12 x 45 Bolt
47.	OEM	Wirng connector
48.	742082	Belt, Micro-V K080610
49.	OEM	Fan plate
50.	OEM	Rubber grommet, fan shroud
51.	OEM	Bolt, fan shroud
52.	110924	M8 x 20 Low head socket bolt
53.	*	Pump, B mount
54.	OEM	Nut, int. tube support

* Pump provided by customer

FIG. 1

BELT DIAGRAM

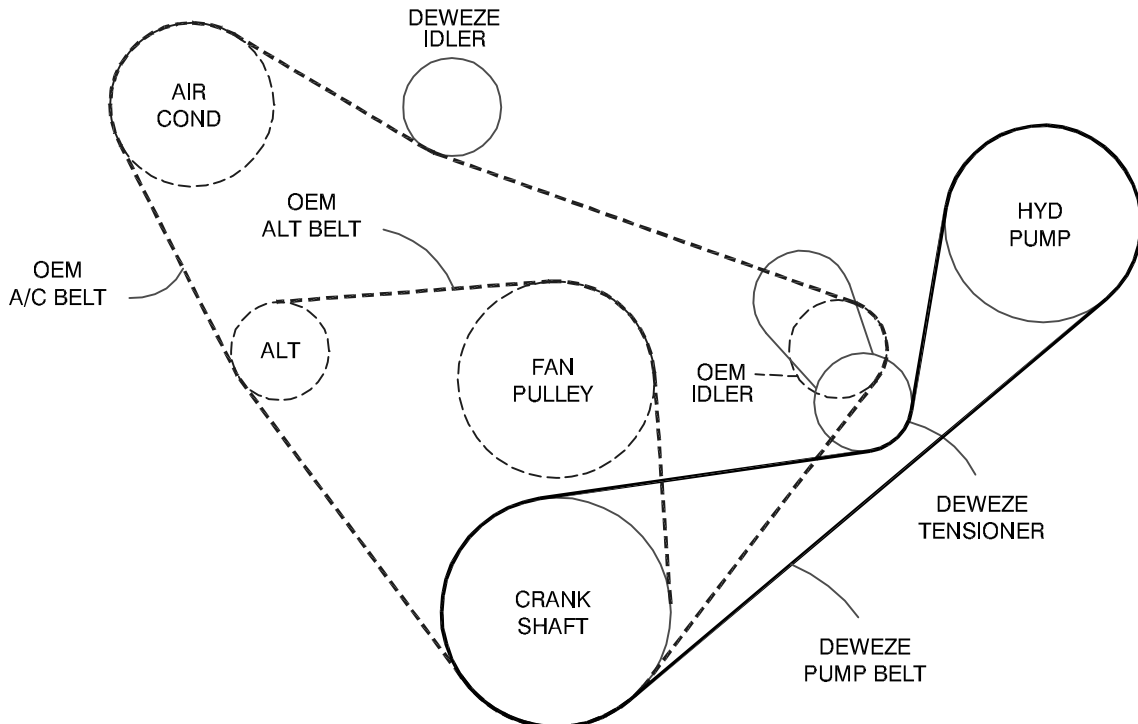

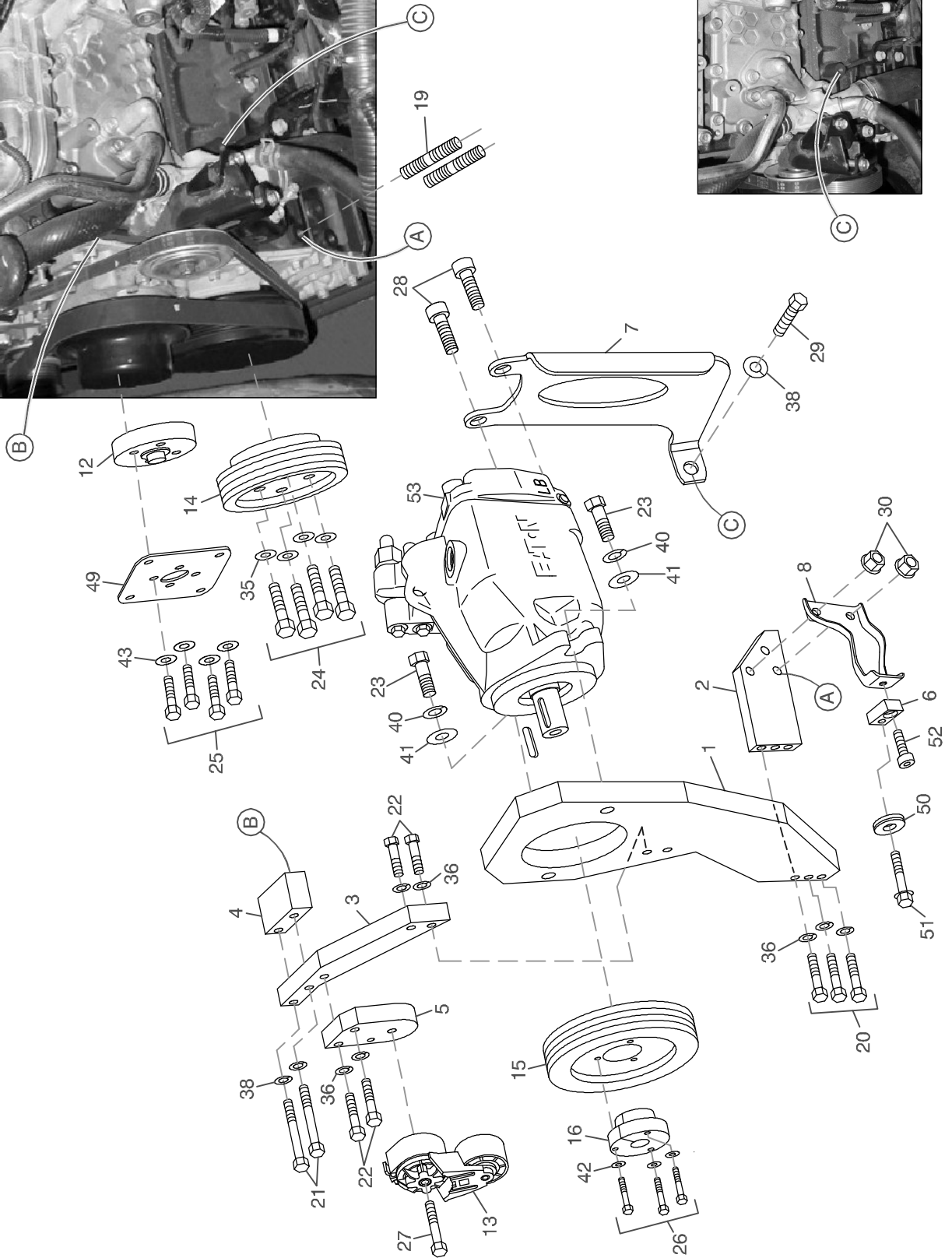
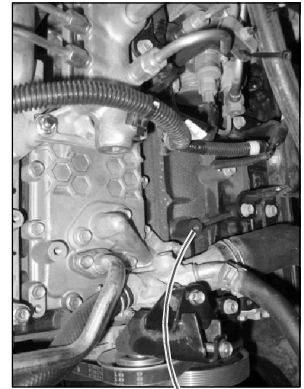

FIG. 2

Fig. 3

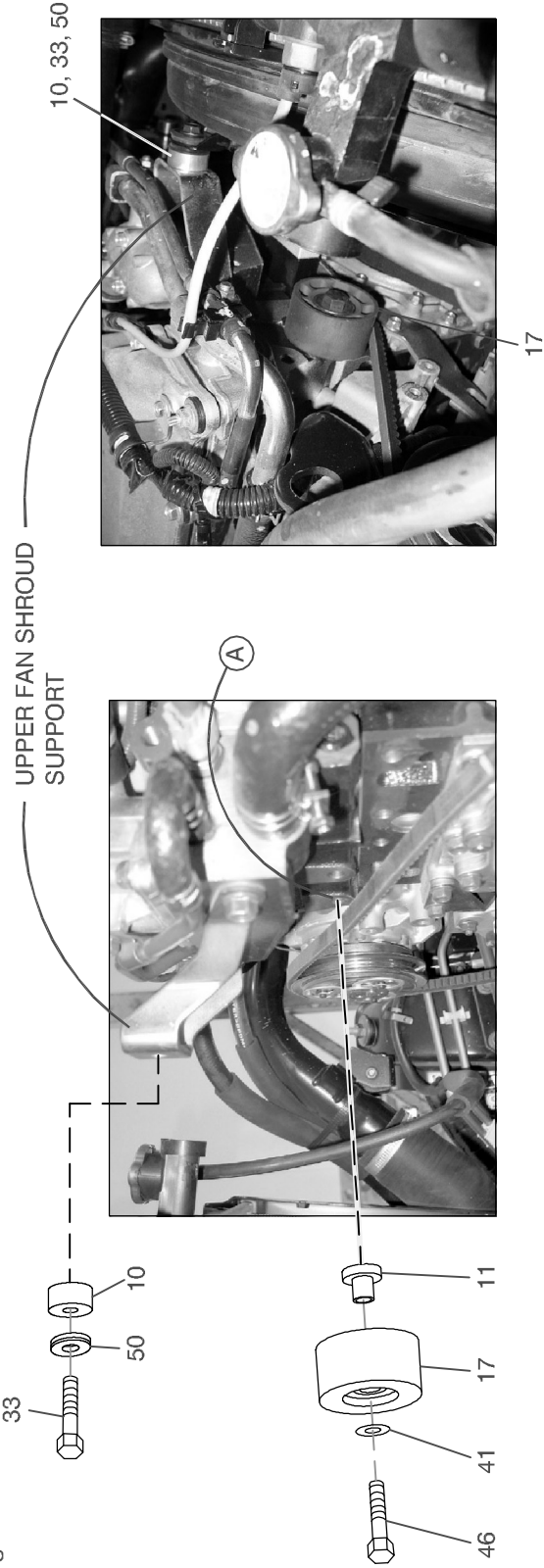
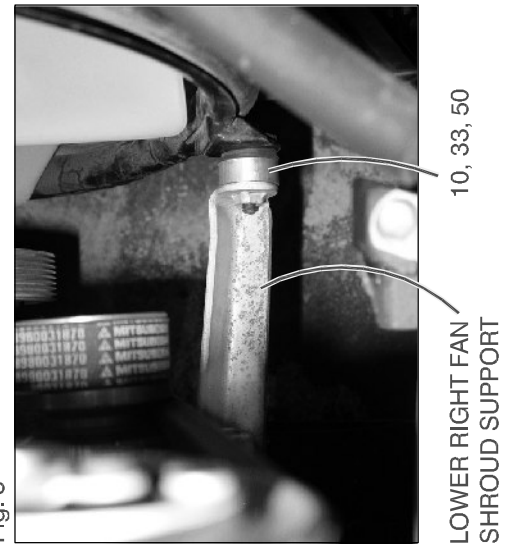
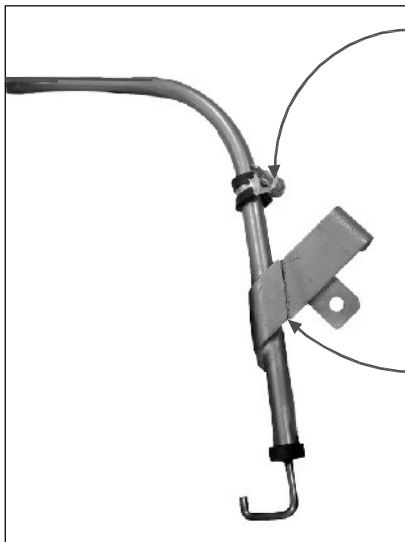

Fig. 5



DIPSTICK - MODIFY AND REPLACE



DIPSTICK MOUNT
32 31 31 9

REMOVE OEM WATER LINE, REPLACE WITH HOSE 18

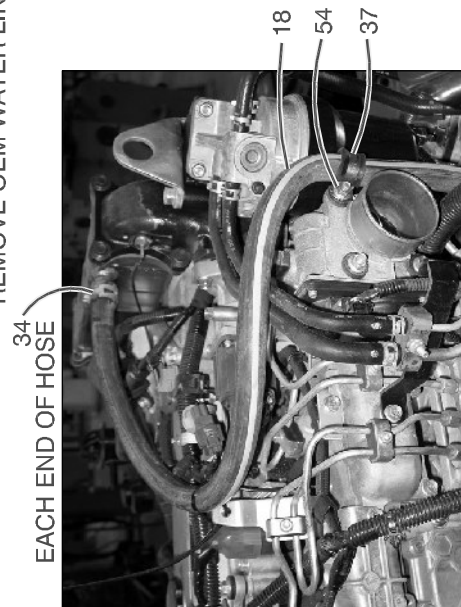

TOP REAR OF ENGINE



BOTTOM TUBE - LEFT FRONT FRAME RAIL

HOSE 18 CONNECTS HERE

34

DewEze

Pump Kit No.
700508
ISUZU NPR
5193 c.c.
2009+

'B' Mount Pump Kit

INSTALLATION INSTRUCTIONS

1. The installation of this kit requires trained decision-making concerning clearances, tying components together, rerouting, or relocating OEM components, etc. It is impossible to describe all of the clearance and vibration points, etc. in the installation instructions. Therefore, the technician must exercise professional judgment to achieve the best quality installation.
2. Disconnect the battery.
3. Drain radiator completely down. Remove upper and lower radiator hoses.
4. Disconnect the wires from intercooler tube and remove tube.
5. Remove water line that runs from top rear of engine to driver's side on the frame rail.
6. Remove dipstick tube, Cut off the mounting bracket.
7. Break fan bolts loose before belts are loosened. Loosen OEM belts.
8. Remove fan and shroud. Remove lower fan shroud bracket on driver's side.
9. Install crank pulley using four M16 x 1.5 x 80 bolts (24) and 1.00 x .625 x 14 ga. flat washers (35). Install the fan spacer (12) with four M8 x 1.25 x 45 bolts (25) with four M8 flat washers (43).
10. Insert idler bushing (11) into idler (17) and mount at Location D with the M12 x 1.75 x 45 bolt (46) and 1/2 flat washer (41). Tighten the OEM belts starting with the two alternator belts then the A/C belt last.

Once belts are tight, tighten bolts in fan spacer and crank pulley.
11. Thread two M10 x 52 stud bolts (19) into engine at Location A. Place bottom engine bracket (2) at Location A. Attach fan shroud spacer block (6) to OEM bracket (8) with M8 x 20 low head socket bolt (52). Place OEM fan shroud bracket (8) on the stud bolts, and tighten with two M10 flange nuts (30).
12. Bolt on pump mount bracket (1) using three 3/8-16 x 1 3/4 bolts (20) and 3/8 lock washers (36). Install top support bracket (3) and spacer (4) to engine at Location C using the two M10 x 1.5 x 85 bolts (21) and 7/16 lock washers (38). Bolt support (3) to the rear of the pump plate using two 3/8-16 x 1.5 bolts (22) and 3/8 lock washers (36). Then mount the tensioner bracket (5) using two 3/8-16 x 1.5 bolts (22) and 3/8 lock washers (36).
13. Remove the two lower bolts from the rear of the pump, place rear pump support (7) on the pump and attach with the pump bolts you just removed. Mount pump (53) using two 1/2-13x1.5 bolts (23), 1/2 lock washers (40) and 1/2 flat washers (41). Attach bottom of pump support (7) with M10 x 20 bolt (29) and 7/16 lock washer (38) at Location C.
14. Install 6" drive pulley (15) on to the pump shaft with QD bushing (16) and three 1/4-20 x 1 bolts (26) and 1/4 lock washers (42). Put QD Bushing in pulley and start the bolts. Slide onto the pump shaft until it stops and tighten the bolts.

15. Install the tensioner (13) using the M10 x 1.5 x 75 bolt (27).
16. Install the pump belt (48).
17. Attach dip stick tube bracket (9) to the rear pump support (7) using a 1/4 x 1 self-tapping screw (31). Place smaller Adel clamp (32) around dipstick tube and attach to the bracket (9) with a 1/4 x 1 self-tapping screw (31).
18. Reinstall intercooler tube using the OEM clamps. Plug in the wires back on the tube.
19. Reinstall fan and shroud. Put one shroud spacer (10) on top and one on the lower passenger side using M8 x 1.25 x 40 bolt (33) and OEM rubber grommet (50).
20. Install heater hose (18) in place of waterline using hose clamps (34). Remove nut from intercooler tube inlet, place larger Adel clamp (37) around hose, and attach to inlet with OEM nut.
21. Reinstall upper and lower radiator hoses.
22. Replace coolant. Reconnect battery.
23. Run the engine and check for any clearance or alignment problems. Adjust as needed.